

**LANDSCAPE  
ARCHITECTURE  
PORTFOLIO**

**AIDA  
HERNÁNDEZ**

# **table of contents**

- 3 Garden Design**
- 4 Construction Documents**
- 6 Community Planning and Design**
- 7 Graduate Capstone Project**

# garden design

Small gardens are perfect places to experiment with color and texture. From monochromatic schemes to loud explosions of color, anything goes. Gardens provide us a much needed contact with nature; yet highly edited to suit our taste.

*Illustrative planting plans created for clients of  
Commercial Lawn & Landscaping, Inc.*

SketchUp and Photoshop  
Pen, ink, and marker on drawing paper

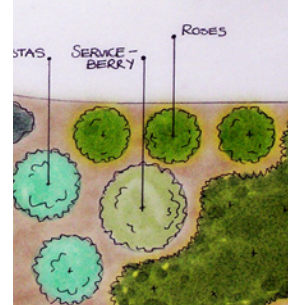
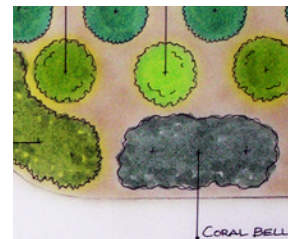



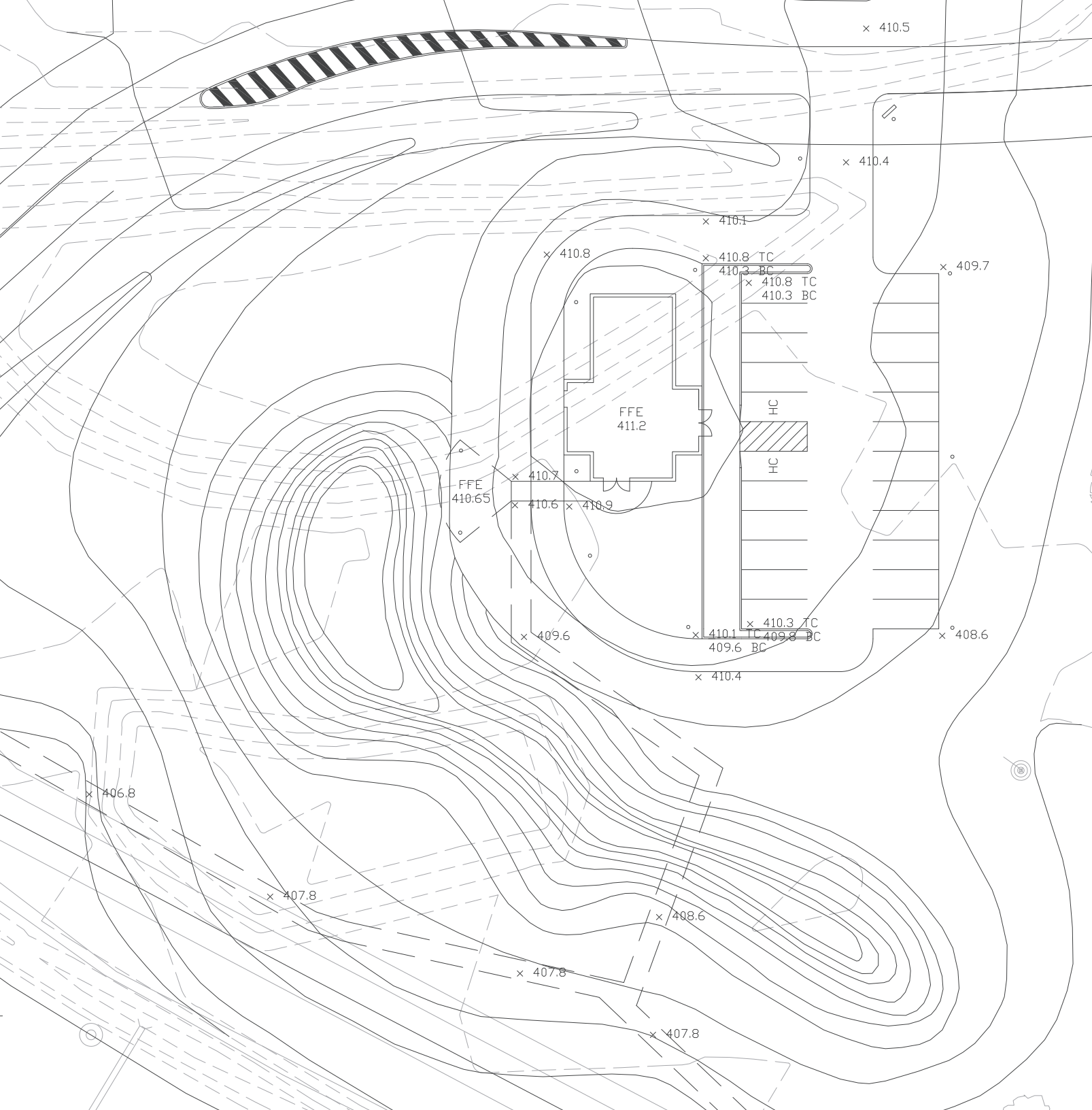

# construction documents

One of the most rewarding moments, as a designer, is to see your work built. Drafting constructions documents brings together the art of design and the precise math of physics to ensure that the spaces we have imagined are comfortable, accessible, and safe.

*Excerpt from grading plan produced for a graduate studio*

AutoCAD

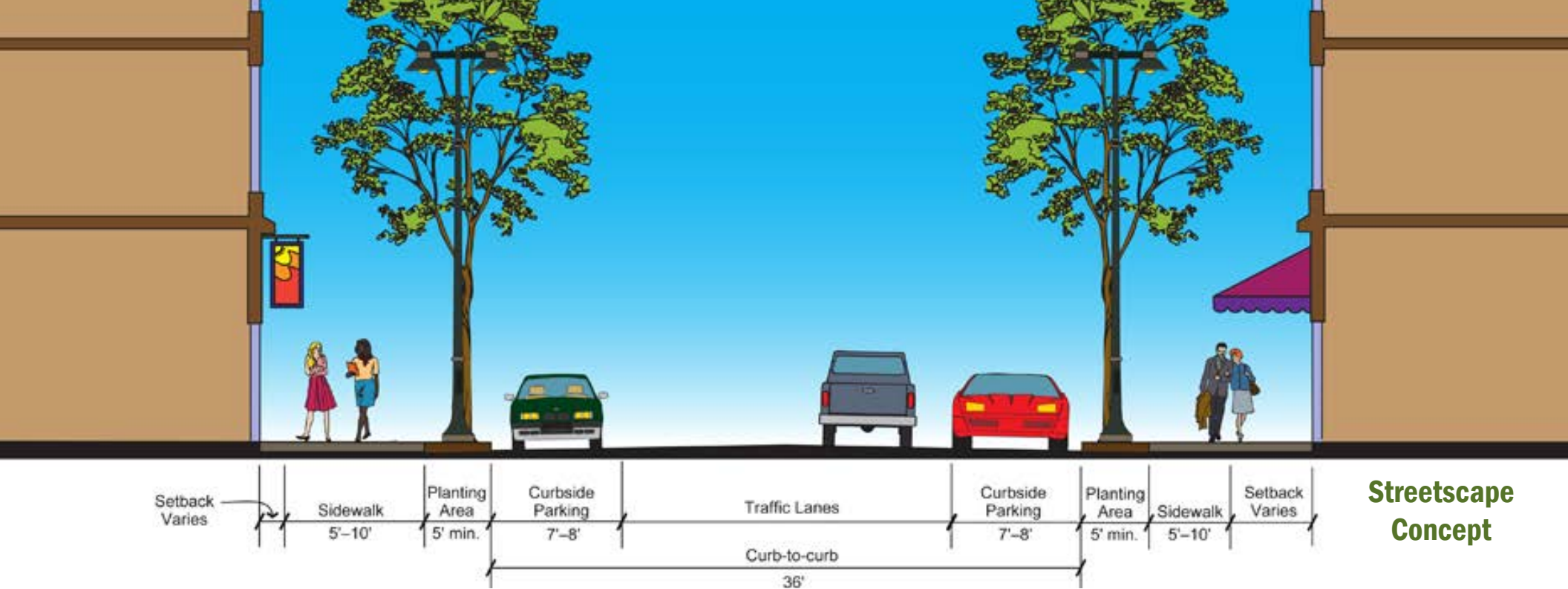

## Streetscape Concept



## construction documents

AutoCAD drafting does not need to be black and white and boring in order to show the precise configuration of space. Color rendering brings images to life, becoming an invaluable tool for selling our vision to clients.

*Excerpts from rendered construction documents produced for a graduate studio*

AutoCAD and Photoshop



# community planning and design

The purpose of the Comstock and Euclid Avenue Intersection Image Study was to explore the way that important neighborhood gateways can be improved to serve as better pedestrian and vehicular environments. The focus of this analysis was how to give these gateways the presence they need to highlight the area's character, community diversity, and provide a way to orient oneself in the neighborhood. The goal of the study was to improve these gateways in aesthetic and functional ways and also establish a connection between them. The repetition of elements such as plantings, crosswalks, bus shelters, and street signs helps to visually establish this connection.

*Second Year Graduate Thematic Studio: Syracuse University Neighborhood Housing Plan*

*Photoshop and Illustrator*

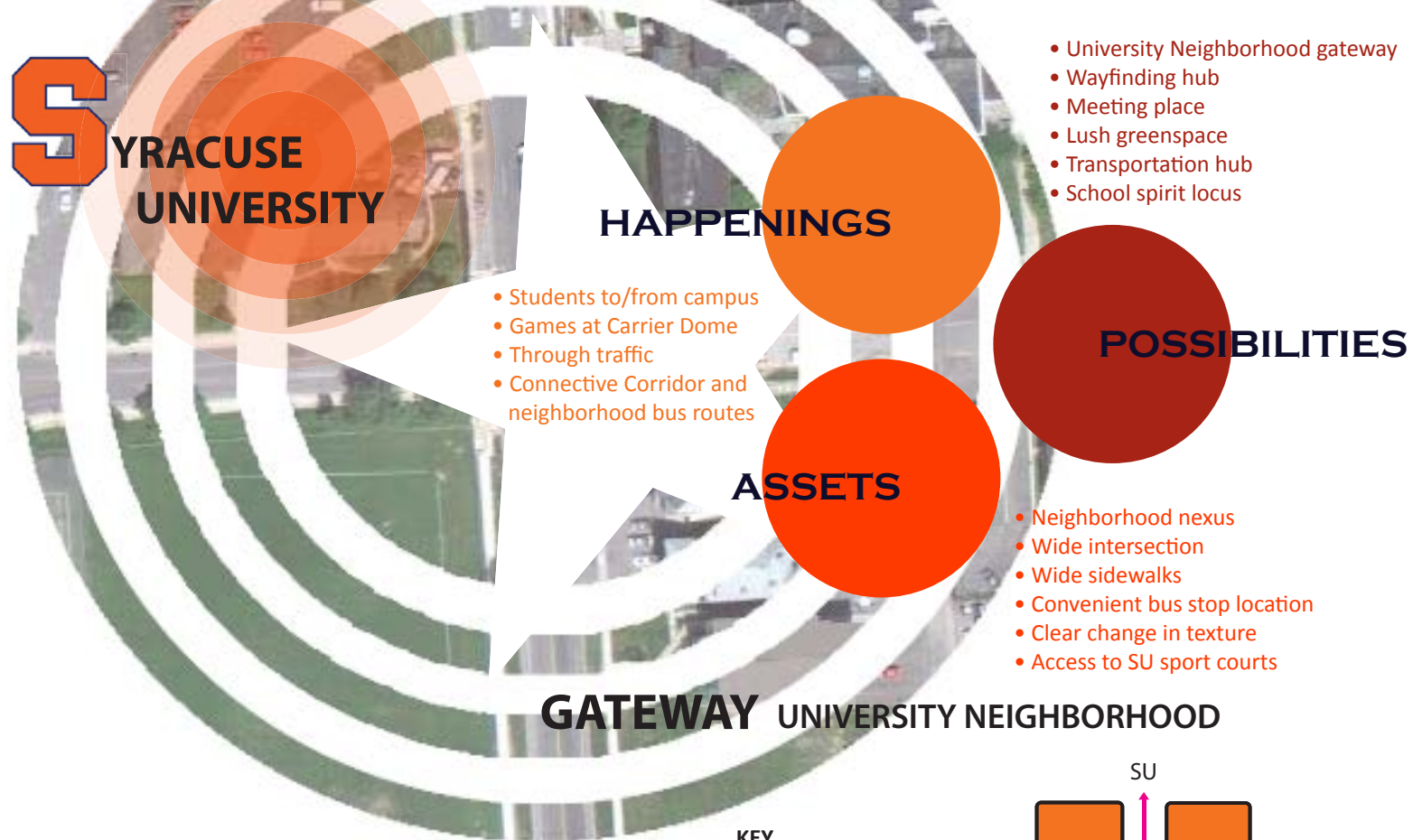

- University Neighborhood gateway
- Wayfinding hub
- Meeting place
- Lush greenspace
- Transportation hub
- School spirit locus

- Students to/from campus
- Games at Carrier Dome
- Through traffic
- Connective Corridor and neighborhood bus routes

- Neighborhood nexus
- Wide intersection
- Wide sidewalks
- Convenient bus stop location
- Clear change in texture
- Access to SU sport courts

**KEY**

- SU
- RENTAL
- OPEN SPACE
- MAIN PEDESTRIAN ROUTE

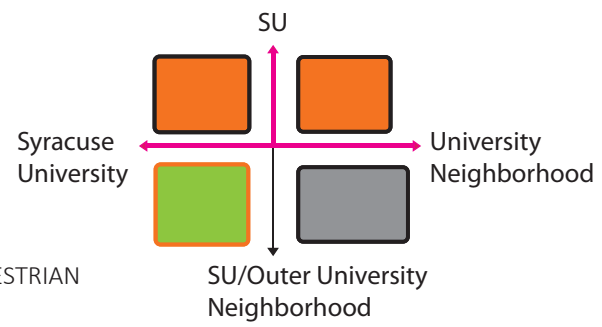

# graduate capstone project

The ecological rehabilitation of brownfield sites can serve as an incentive for community revitalization. The outlet of Nine Mile Creek into Onondaga Lake and the adjacent areas have long been impacted by industrial pollution. Designing for recreation and education activities that were compatible with the integrity of the rehabilitation strategies evaluated was a major objective of this capstone project. To demonstrate the catalytic potential of ecological rehabilitation in a specific landscape of clean-up and reclamation is to enrich the biological diversity of the area, reconnect people to the land, and continue to pique interest in revitalizing the surrounding areas.

*“Ecology, Recreation and Education: Strategies for Rehabilitating the Nine Mile Creek Outlet in Syracuse, NY”*

AutoCAD, Photoshop, and Illustrator

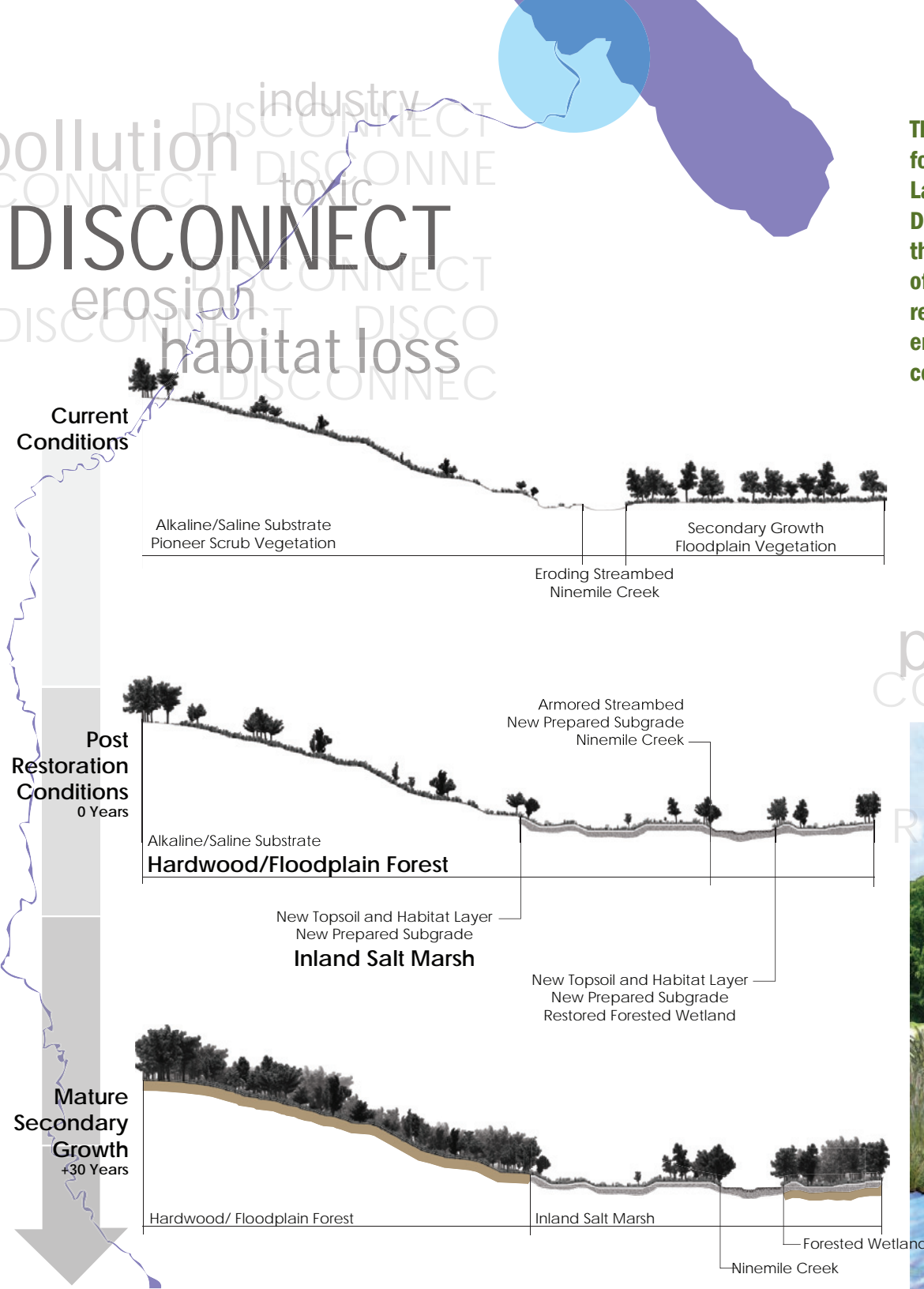



# graduate capstone project

The proposed Ninemile Creek Landscape Park seeks to be a premier recreation destination in Syracuse and the whole Central New York area. With close to 3.5 miles of proposed multi-use trails on just over 600 acres, visitors would be able to enjoy leisurely strolling, jogging and cycling. The water trail that starts in the Village of Camillus is extended through the park with additional canoe launches and parking spots along the way. Catch-and-Release fishing is allowed. Ample opportunities for birdwatching and monitoring exist. Gardens and rehabilitated

native plant communities present unique recreational opportunities such as blooming events and rare species identification and monitoring. Finally, with a proposed visitor's center available for a wide range of public and private events, the Nine Mile Creek Landscape Park hopes that through recreational and educational opportunities users will reconnect to the land in meaningful ways and foster a deep sense of stewardship toward nature.

**“Ecology, Recreation and Education: Strategies for Rehabilitating the Nine Mile Creek Outlet in Syracuse, NY”**

**AutoCAD, Photoshop, and Illustrator**

## Ninemile Creek Landscape Park Master Plan



- Key**
- Inland Salt Marsh
  - Hardwood/Floodplain Forest
  - Floodplain Forest



**thanks for looking!**

